

Installation Guide

For retrofitting the internal USB cable in certain types of Ecolab dispensing units, please follow the steps outlined in this installation guide.

When servicing the dispensing systems in the field, the **USB cable SDX** can be used by the Ecolab technician for data transfer and analyses.

If this USB cable is not implemented, **retrofitting** is possible for the following dispensing systems:

If the USB cable has already been installed, you will find a cover flap on the devices in the **marked locations**.

SYSTEM	EE CODE	EBS CODE
Ecoplus SDRX	172114	10016149
Ecoplus PDRX	172120	10055274
EXN-II	123542	10052564
Turbo Smart Twin II (INST & F&B)	123571	10023473
Ecoplus PDRX UK	10240068	10240068

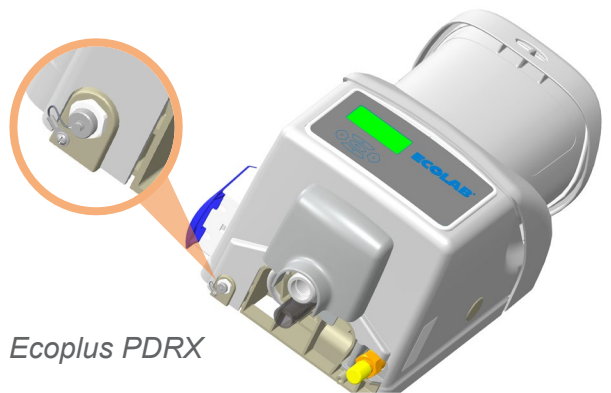

Ecoplus PDRX

For retrofitting please order:

Retrofit Kit USB Cable SDX

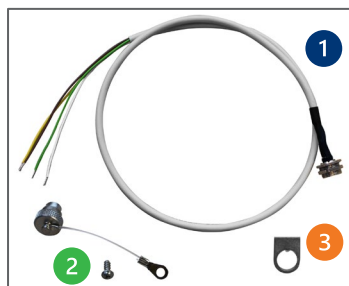

EE / EBS article number 10240845

- 1 cable with flange socket
- 2 cover flap with screw
- 3 anti-rotation device

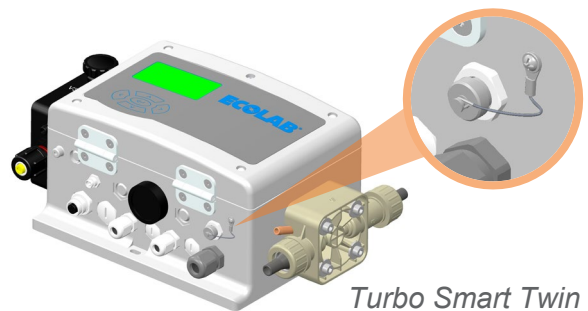

Turbo Smart Twin II

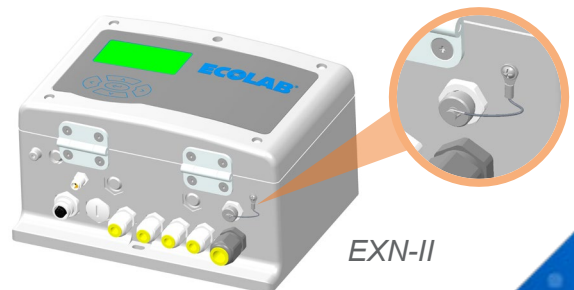

EXN-II

In the following, you will find the detailed guides to the retrofitting process for the Ecoplus PDRX and the Turbo Smart Twin II. Proceed accordingly with the other dosing systems, Ecoplus SDRX and EXN II.

Installation Guide

The following instructions describe the retrofitting of the USB cable using the EcoPlus PDRX dispensing unit as an example.

For installing the retrofitting kit, opening the EcoPlus housing is necessary. For this, please also refer to the *Operating Instructions* (especially chapters on *Assembly and Installation*). Please also follow the **safety instructions** outlined in the respective manual.



1 Unlock and remove the **funnel lock**. | 2 Remove the **funnel**. | 3 Unlock the front housing (buttons on sides) and remove it. | 4 Press the two tabs on the **electronics unit** and lift it off the device rear panel. | 5 Unlock the four tabs of the **electronic unit cover** and remove it.



5 Prepare USB cable by frontally sliding the **anti-rotation device** over the flange socket.

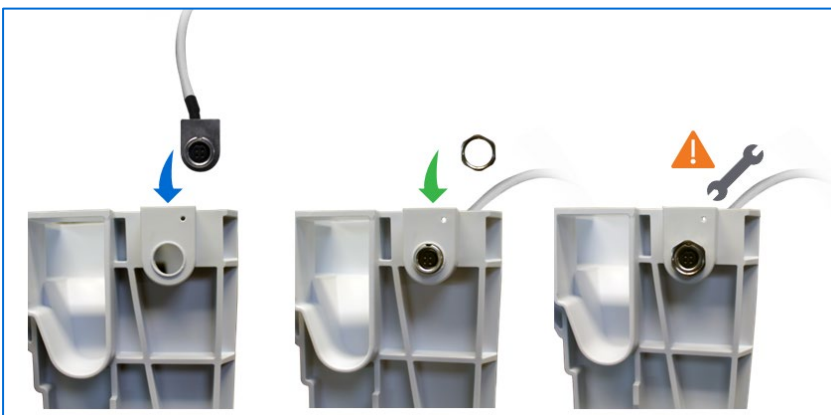

6 Insert the **flange socket** into the slot on the bottom of the housing rear panel.

7 Place the **locknut** on the outside and **tighten it**.

Installation Guide (continued)

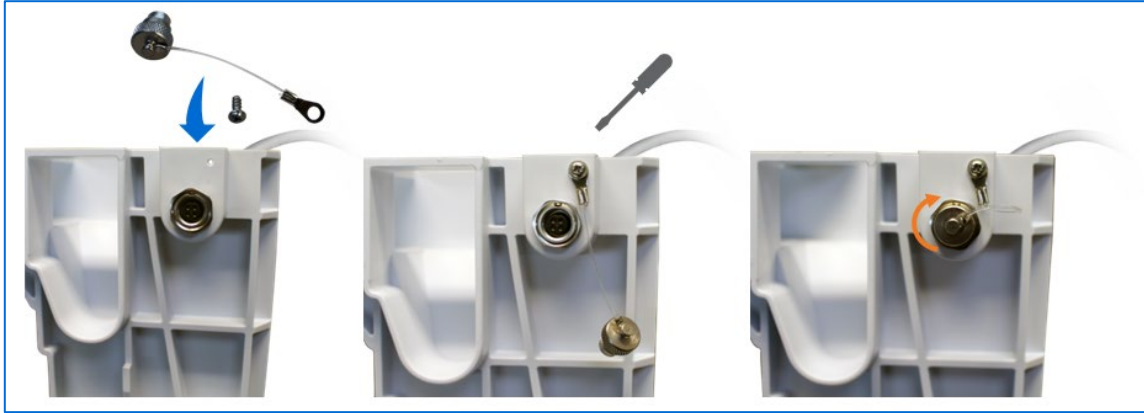

8 Attach the **cover flap** to the housing, insert it into the flange socket and **screw it tight**.

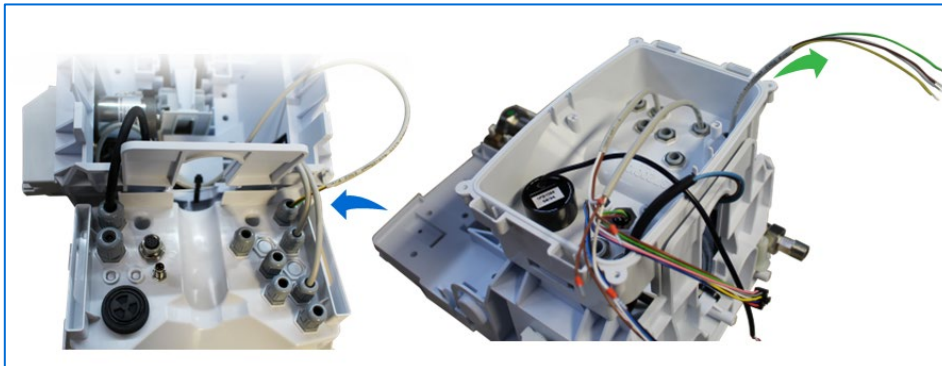

9 Guide the USB cable through the **cable union** on the bottom of the electronics unit as shown. Reattach the electronics unit housing to the rear panel of the device.

10 Pull the **USB cable** up to the maximum.

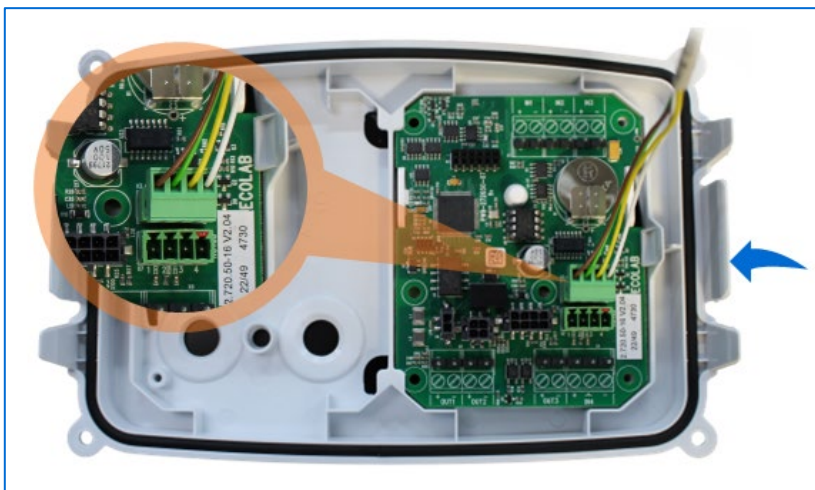

11 Insert the **wires** of the USB cable into the green – already pre-mounted – **female connector**. Please observe the illustrated **color assignment** of the wires.

The connector slots are numbered. The color assignment is:

- 1 = WH (white)
- 2 = YE (yellow)
- 3 = GN (green)
- 4 = BN (brown)

Installation Guide (continued)

The following instructions refer the retrofitting of the USB cable on the Turbo Smart Twin II. The process is analogue to the retrofitting on the EcoPlus PDRX described above.

For installing the retrofitting kit, opening the Turbo Smart Twin II housing is necessary. Please also refer to the **safety instructions** outlined in the respective manual.



1 Open the Turbo Smart Twin II housing by loosening the **screw** in the middle of the front cover.

2 Open the front cover.

3 Insert the **flange socket** into the hole of the rear part of the housing and fasten it from the outside with the locknut. **Note:** For the Turbo Smart Twin II (or the EXN-II), you do not need the anti-rotation device.

4 Run the cable inside the housing to the other side, loosen the cable tie holding the other wires, bundle the wires together with those of the USB cable and renew the **green cable tie**.

5 Insert the wires of the USB cable into the green – already pre-mounted – **female connector** on the PCB. Please observe the illustrated **color assignment** of the wires.

6 Close the Turbo Smart Twin II housing by tightening the screw in the middle of the front cover.

7 Attach the **cover flap** to the housing, insert it into the flange socket and **screw it tight**.

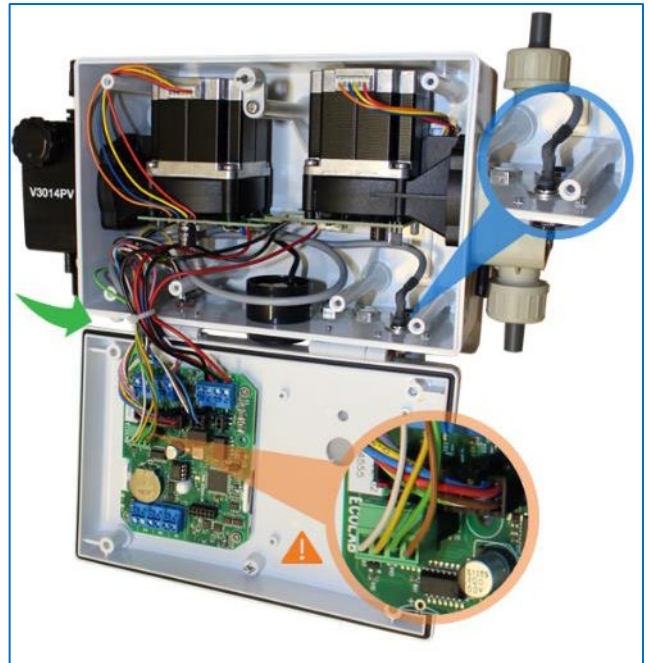

The connector slots are numbered.

The color assignment is:

- 1 = WH (white)
- 2 = YE (yellow)
- 3 = GN (green)
- 4 = BN (brown)

